



Evans PW-HB/Presslok Series

PCW Tee's, Elbows, Manifolds, Adapters w/ Hose Barb or Presslok End



PW-HB SERIES FITTINGS

- 1/4" - 2" Sizes (1/4" - 1" fittings use only approved Evans Components, Push-Lok barbs; Ham-Let or Parker; 1 1/2" - 2" fittings use Evans Components or Dixon RST* HB)
- Optional Presslok Connections 1 1/2" - 3" sizes
- Stainless, welded construction
- 3" thru 1" FPOC's use ANSI 150 # Van Stone Flg (Rotating Flg)
- All components pressure rated to 150 psig /10 Bar max. @ 185° F/ 85° C
- He leak tested to 1 x 10⁻⁷ scc/sec
- Dimensional tolerances are +/- .20"
- Evans O-Ring Wafers x Hose Barbs for SS unions for Sticks and Valves
- All assemblies bagged and labeled in ISO 5 (Class 100) cleanroom
- 3-D MODELS/DWGS AVAILABLE

Evans PW Series Index

<p>PW 3</p> <p>Multiple Branch, Multiple Orientation HB/PL Manifold</p> 	<p>PW 8</p> <p>ANSI X 90° HB Rotatable</p> 	<p>PW 13</p> <p>MNPT Union X HB W/ Drain</p> 	<p>PW 16</p> <p>Union Nut</p> 
<p>PW 4</p> <p>Multiple Branch, HB/PL Manifold</p> 	<p>PW 8</p> <p>ANSI X 90° HB W/ Drain Rotatable</p> 	<p>PW 14</p> <p>HB x Tube 90° Elbow</p> 	<p>PW 16</p> <p>NPT x O-ring Wafer</p> 
<p>PW 4</p> <p>Reducing Run HB/PL Tee, Single Branch</p> 	<p>PW 9</p> <p>ANSI X 45° HB Rotatable</p> 	<p>PW 14</p> <p>HB x Tube 45° Elbow</p> 	<p>PW 16</p> <p>Presslok x O-ring Wafer</p> 
<p>PW 5</p> <p>HB Equal Tee</p> 	<p>PW 9</p> <p>ANSI X 45° HB W/ Drain Rotatable</p> 	<p>PW 14</p> <p>HB Plug x Compression Cap</p> 	<p>PW 16</p> <p>Tube x O-ring Wafer</p> 
<p>PW 5</p> <p>Reducing Branch Tee</p> 	<p>PW 10</p> <p>ANSI X HB Tee Rotatable</p> 	<p>PW 15</p> <p>HB x Wafer PW Stick Adapter</p> 	<p>PW 17</p> <p>HB x HB Ball Valves</p> 
<p>PW 6</p> <p>90° HB Elbow</p> 	<p>PW 12</p> <p>MNPT Union X HB Tee</p> 	<p>PW 15</p> <p>90° HB Elbow x Wafer PW Stick Adapter</p> 	<p>PW 18</p> <p>HB x ANSI Ball Valves</p> 
<p>PW 7</p> <p>ANSI X HB</p> 	<p>PW 13</p> <p>MNPT Union X 90° HB W/ Drain</p> 	<p>PW 15</p> <p>45° HB Elbow x Wafer PW Stick Adapter</p> 	<p>PW 19</p> <p>HB x HB Globe Valves</p> 
<p>PW 7</p> <p>ANSI X HB W/ Drain Rotatable</p> 	<p>PW 13</p> <p>MNPT Union X 45° HB W/ Drain</p> 	<p>PW 16</p> <p>MNPT x Threaded Wafer</p> 	

Hose Barb Manifolds

Manifold

Multiple Orientations

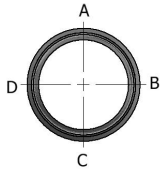

VIEW A-A
ORIENTATION

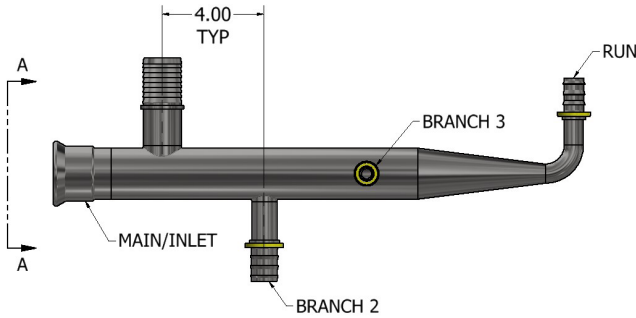

Part Number Matrix

PW - 1 2 3 T 4* - 5 2 4 - 5 2 4 ... - 6 2 4* - 7

EXAMPLE: PW-32PL3T-24HBA-16HBC-08HBB-12HBA-E

2" PRESSLOK INLET, 2" MAIN, 1.5" "A" HB BRANCH, 1" "C" HB BRANCH, 1/2" "B" HB BRANCH, 3/4" "A" HB RUN, EPDM O-RING

* If Inlet or Run is straight, leave orientation (4) blank

- | | | |
|--|--|---|
| <p>1. Inlet/Main Size
08 - 1/2"
12 - 3/4"
16 - 1"
24 - 1-1/2"
32 - 2"
48 - 3"</p> | <p>4. Orientation
(First Branch is always "A")</p> <p>5. Branch Size
04 - 1/4"
06 - 3/8"
08 - 1/2"
12 - 3/4"
16 - 1"
24 - 1-1/2"
32 - 2"</p> | <p>6. Run Size
04 - 1/4"
06 - 3/8"
08 - 1/2"
12 - 3/4"
16 - 1"
24 - 1-1/2"
32 - 2"</p> |
| <p>2. Connection
PL - Presslok
HB - Hosebarb</p> | <p>7. O-Ring Material
E - EPDM
V - VITON</p> | |
| <p>3. Number of Branches</p> | | |

Hose Clamp "Go" Inspection Gauges

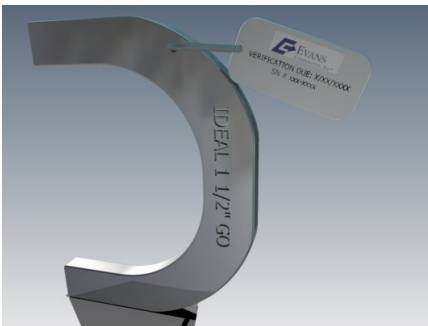

Part Number	Hose Barb Size	Hose Clamp Type
GG-24-IDEAL-SS	1-1/2"	Ideal
GG-32-IDEAL-SS	2"	Ideal
GG-24-BANDIT-SS	1-1/2"	Band-It
GG-32-BANDIT-SS	2"	Band-It

NOTE: all dimensions are +/- .20"

* Inspection gauges to be sent back to Evans by the expiration date listed on tag for inspection & recertification

Manifolds

Manifold

Reducing Run Tee, Multiple branches, Same Orientation

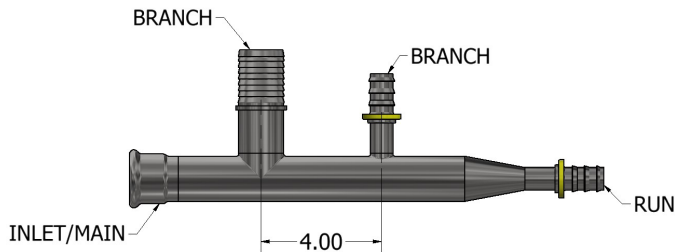

Part Number Matrix

PW - 1 2 3 T - 4 2 - 4 2 ... - 5 2 - 6

EXAMPLE: PW-24PL2T-24HB-12HB-08HB-E

1.5" PRESSLOK INLET, 1.5" MAIN, 1.5" HB BRANCH, 3/4" HB BRANCH 1/2" HB RUN, EPDM O-RING

1. Inlet HB/Main Size	4. Branch Size	5. Run Size
08 - 1/2"	04 - 1/4"	04 - 1/4"
12 - 3/4"	06 - 3/8"	06 - 3/8"
16 - 1"	08 - 1/2"	08 - 1/2"
24 - 1-1/2"	12 - 3/4"	12 - 3/4"
32 - 2"	16 - 1"	16 - 1"
48 - 3"	24 - 1-1/2"	24 - 1-1/2"
	32 - 2"	32 - 2"
2. Connection		6. O-Ring Material
PL - Presslok		E - EPDM
HB - Hosebarb		V - VITON
3. Number of Branches		

Manifold

Reducing Run Tee, Single branch

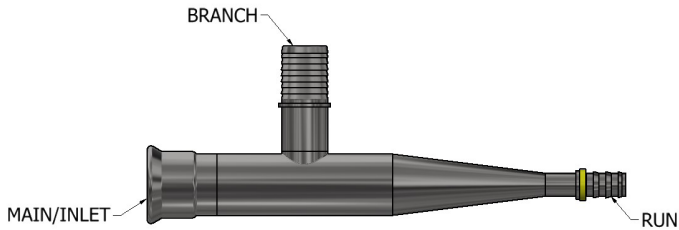

Part Number Matrix

PW - 1 2 T - 3 2 - 4 2 - 5

EXAMPLE: PW-32PLT-24HB-12HB-E

2" PRESSLOK INLET, 2" MAIN, 1.5" HB BRANCH, 3/4" HB RUN, EPDM O-RING

1. Inlet/Main Size	3. Branch Size	4. Run Size
08 - 1/2"	04 - 1/4"	04 - 1/4"
12 - 3/4"	06 - 3/8"	06 - 3/8"
16 - 1"	08 - 1/2"	08 - 1/2"
24 - 1-1/2"	12 - 3/4"	12 - 3/4"
32 - 2"	16 - 1"	16 - 1"
48 - 3"	24 - 1-1/2"	24 - 1-1/2"
	32 - 2"	32 - 2"
2. Connection		5. O-Ring Material
PL - Presslok		E - EPDM
HB - Hosebarb		V - VITON

Hose Barb Tees

Hose Barb Equal Tees

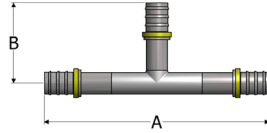

Part Number	Size	Dimension "A"	Dimension "B"
PW-06HBT	3/8"	7.07"	2.21"
PW-08HBT	1/2"	8.07"	2.51"
PW-12HBT	3/4"	9.26"	3.11"
PW-16HBT	1"	8.19"	3.73"
PW-24HBT	1-1/2"	11.63"	4.29"
PW-32HBT	2"	12.63"	4.54"

Hose Barb Reducing Branch Tee's

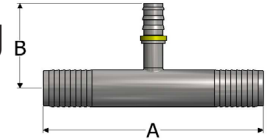

Part Number	Size	Dimension "A"	Dimension "B"
PW-08HBT-06HB	1/2" x 3/8"	8.07"	2.21"
PW-12HBT-06HB	3/4" x 3/8"	9.26"	2.21"
PW-12HBT-08HB	3/4" x 1/2"	9.26"	2.51"
PW-16HBT-08HB	1" x 1/2"	8.19"	2.76"
PW-16HBT-12HB	1" x 3/4"	10.51"	3.23"
PW-24HBT-08HB	1-1/2" x 1/2"	11.63"	3.01"
PW-24HBT-12HB	1-1/2" x 3/4"	11.63"	3.48"
PW-24HBT-16HB	1-1/2" x 1"	11.63"	3.98"
PW-32HBT-08HB	2" x 1/2"	12.63"	3.26"
PW-32HBT-12HB	2" x 3/4"	12.63"	3.73"
PW-32HBT-16HB	2" x 1"	13.11"	4.23"
PW-32HBT-24HB	2" x 1-1/2"	13.11"	4.54"

Refer to PLT Series Presslok catalog (Pg. 16) for Presslok x HB Tees

Hose Barb Elbows

Hose Barb 90° Elbows

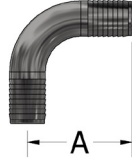

Part Number	Size	Dimension "A"
PW-08HB-90	1/2"	8.07"
PW-12HB-90	3/4"	9.26"
PW-16HB-90	1"	8.19"
PW-24HB-90	1-1/2"	11.63"
PW-32HB-90	2"	12.63"

*Refer to PLT Series Presslok catalog
(Pg. 15) for Presslok x HB Elbows*

150# ANSI Flanges

ANSI FLG X

Straight HB W/ 3/8" - 2" HB End

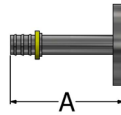

ANSI VAN Stone FLG X

Straight HB W/ 3/8" - 2" HB End W/ 1/2" Vent/Drain

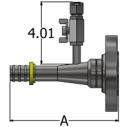

1" ANSI Flange		
Part Number	HB Size	Dimension "A"
PW-16U-06HB	3/8"	5.75"
PW-16U-08HB	1/2"	5.43"
PW-16U-12HB	3/4"	5.93"
PW-16U-16HB	1"	6.09"
PW-16U-24HB	1 1/2"	6.07"
PW-16U-32HB	2"	6.25"
1-1/2" ANSI Flange		
PW-24U-06HB	C/F	C/F
PW-24U-08HB	C/F	C/F
PW-24U-12HB	C/F	C/F
PW-24U-16HB	C/F	C/F
PW-24U-24HB	C/F	C/F
PW-24U-32HB	C/F	C/F
2" ANSI Flange		
PW-32U-06HB	C/F	C/F
PW-32U-08HB	C/F	C/F
PW-32U-12HB	C/F	C/F
PW-32U-16HB	C/F	C/F
PW-32U-24HB	C/F	C/F
PW-32U-32HB	C/F	C/F
3" ANSI Flange		
PW-48U-06HB	3/8"	5.75"
PW-48U-08HB	1/2"	5.75"
PW-48U-12HB	3/4"	5.93"
PW-48U-16HB	1"	6.09"
PW-48U-24HB	1 1/2"	6.07"
PW-48U-32HB	2"	6.25"

1" ANSI Flange		
Part Number	HB Size	Dimension "A"
PW-16RU-06HB-08DV	3/8"	5.14"
PW-16RU-08HB-08DV	1/2"	5.04"
PW-16RU-12HB-08DV	3/4"	5.44"
PW-16RU-16HB-08DV	1"	5.77"
PW-16RU-24HB-08DV	1 1/2"	5.88"
PW-16RU-32HB-08DV	2"	6.62"
1-1/2" ANSI Flange		
PW-24RU-06HB-08DV	C/F	C/F
PW-24RU-08HB-08DV	C/F	C/F
PW-24RU-12HB-08DV	C/F	C/F
PW-24RU-16HB-08DV	C/F	C/F
PW-24RU-24HB-08DV	C/F	C/F
PW-24RU-32HB-08DV	C/F	C/F
2" ANSI Flange		
PW-32RU-06HB-08DV	C/F	C/F
PW-32RU-08HB-08DV	C/F	C/F
PW-32RU-12HB-08DV	C/F	C/F
PW-32RU-16HB-08DV	C/F	C/F
PW-32RU-24HB-08DV	C/F	C/F
PW-32RU-32HB-08DV	C/F	C/F
3" ANSI Flange		
PW-48RU-06HB-08DV	3/8"	5.72"
PW-48RU-08HB-08DV	1/2"	6.66"
PW-48RU-12HB-08DV	3/4"	7.13"
PW-48RU-16HB-08DV	1"	6.63"
PW-48RU-24HB-08DV	1 1/2"	5.69"
PW-48RU-32HB-08DV	2"	7.93"

Refer to PLT Series Presslok catalog (Pg. 23) for Presslok x ANSI Flanges

150# ANSI Flanges



ANSI VAN Stone FLG x 90 Degree Elbow W/ 3/8" Thru 2" HB End

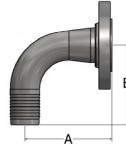

ANSI VAN Stone FLG x 90 De-gree Elbow W/ 3/8" Thru 2" HB End W/ 1/2" Vent/Drain Valve

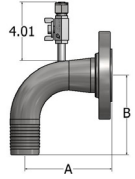

1" ANSI Flange			
Part Number	HB Size	Dimension "A"	Dimension "B"
PW-16RU-ET-06HB	3/8"	4.16"	2.34"
PW-16RU-ET-08HB	1/2"	4.16"	2.50"
PW-16RU-ET-12HB	3/4"	4.16"	3.75"
PW-16RU-ET-16HB	1"	3.54"	4.63"
PW-16RU-ET-24HB	1-1/2"	4.69"	4.44"
PW-16RU-ET-32HB	2"	7.18"	5.44"
1 1/2" ANSI Flange			
PW-24RU-ET-06HB	3/8"	C/F	C/F
PW-24RU-ET-08HB	1/2"	C/F	C/F
PW-24RU-ET-12HB	3/4"	C/F	C/F
PW-24RU-ET-16HB	1"	C/F	C/F
PW-24RU-ET-24HB	1-1/2"	C/F	C/F
PW-24RU-ET-32HB	2"	C/F	C/F
2" ANSI Flange			
PW-32RU-ET-06HB	3/8"	C/F	C/F
PW-32RU-ET-08HB	1/2"	C/F	C/F
PW-32RU-ET-12HB	3/4"	C/F	C/F
PW-32RU-ET-16HB	1"	C/F	C/F
PW-32RU-ET-24HB	1-1/2"	C/F	C/F
PW-32RU-ET-32HB	2"	C/F	C/F
3" ANSI Flange			
PW-48RU-ET-06HB	3/8"	5.36"	2.50"
PW-48RU-ET-08HB	1/2"	5.36"	2.50"
PW-48RU-ET-12HB	3/4"	5.24"	3.75"
PW-48RU-ET-16HB	1"	5.62"	4.63"
PW-48RU-ET-24HB	1-1/2"	4.18"	4.44"
PW-48RU-ET-32HB	2"	6.12"	5.62"

1" ANSI Flange			
Part Number	HB Size	Dimension "A"	Dimension "B"
PW-16RU-ET-06HB-08DV	3/8"	4.01"	2.34"
PW-16RU-ET-08HB-08DV	1/2"	4.01"	3.29"
PW-16RU-ET-12HB-08DV	3/4"	3.94"	3.75"
PW-16RU-ET-16HB-08DV	1"	4.14"	4.63"
PW-16RU-ET-24HB-08DV	1-1/2"	4.43"	4.44"
PW-16RU-ET-32HB-08DV	2"	7.18"	5.44"
1 1/2" ANSI Flange			
PW-24RU-ET-06HB-08DV	3/8"	C/F	C/F
PW-24RU-ET-08HB-08DV	1/2"	C/F	C/F
PW-24RU-ET-12HB-08DV	3/4"	C/F	C/F
PW-24RU-ET-16HB-08DV	1"	C/F	C/F
PW-24RU-ET-24HB-08DV	1-1/2"	C/F	C/F
PW-24RU-ET-32HB-08DV	2"	C/F	C/F
2" ANSI Flange			
PW-32RU-ET-06HB-08DV	3/8"	C/F	C/F
PW-32RU-ET-08HB-08DV	1/2"	C/F	C/F
PW-32RU-ET-12HB-08DV	3/4"	C/F	C/F
PW-32RU-ET-16HB-08DV	1"	C/F	C/F
PW-32RU-ET-24HB-08DV	1-1/2"	C/F	C/F
PW-32RU-ET-32HB-08DV	2"	C/F	C/F
3" ANSI Flange			
PW-48RU-ET-06HB-08DV	3/8"	5.36"	2.34"
PW-48RU-ET-08HB-08DV	1/2"	5.36"	3.28"
PW-48RU-ET-12HB-08DV	3/4"	5.34"	3.75"
PW-48RU-ET-16HB-08DV	1"	5.70"	4.63"
PW-48RU-ET-24HB-08DV	1-1/2"	6.39"	4.44"
PW-48RU-ET-32HB-08DV	2"	7.05"	5.44"

Refer to PLT Series Presslok catalog (Pg. 24) for Presslok x ANSI Elbows

150# ANSI Flanges

ANSI VAN Stone FLG

x 45° Elbow W/ 3/8" - 2" HB End

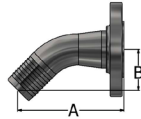

ANSI VAN Stone FLG

x 45° Elbow W/ 3/8" - 2" HB End W/ 1/2" Vent/Drain

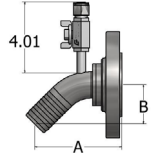

1" ANSI Flange			
Part Number	HB Size	Dimension "A"	Dimension "B"
PW-16RU-ET45-06HB	3/8"	4.54"	1.19"
PW-16RU-ET45-08HB	1/2"	5.20"	1.86"
PW-16RU-ET45-12HB	3/4"	5.47"	2.19"
PW-16RU-ET45-16HB	1"	6.02"	2.55"
PW-16RU-ET45-24HB	1 1/2"	5.33"	2.21"
PW-16RU-ET45-32HB	2"	8.04"	2.61"
1 1/2" ANSI Flange			
PW-24RU-ET45-06HB	3/8"	C/F	C/F
PW-24RU-ET45-08HB	1/2"	C/F	C/F
PW-24RU-ET45-12HB	3/4"	C/F	C/F
PW-24RU-ET45-16HB	1"	C/F	C/F
PW-24RU-ET45-24HB	1 1/2"	C/F	C/F
PW-24RU-ET45-32HB	2"	C/F	C/F
2" ANSI Flange			
PW-32RU-ET45-06HB	3/8"	C/F	C/F
PW-32RU-ET45-08HB	1/2"	C/F	C/F
PW-32RU-ET45-12HB	3/4"	C/F	C/F
PW-32RU-ET45-16HB	1"	C/F	C/F
PW-32RU-ET45-24HB	1 1/2"	C/F	C/F
PW-32RU-ET45-32HB	2"	C/F	C/F
3" ANSI Flange			
PW-48RU-ET45-06HB	3/8"	5.89"	1.19"
PW-48RU-ET45-08HB	1/2"	6.55"	1.86"
PW-48RU-ET45-12HB	3/4"	6.87"	2.19"
PW-48RU-ET45-16HB	1"	7.48"	2.66"
PW-48RU-ET45-24HB	1 1/2"	7.28"	2.21"
PW-48RU-ET45-32HB	2"	7.91"	2.61"

1" ANSI Flange			
Part Number	HB Size	Dimension "A"	Dimension "B"
PW-16RU-ET45-06HB-08DV	3/8"	4.54"	1.19"
PW-16RU-ET45-08HB-08DV	1/2"	5.20"	1.86"
PW-16RU-ET45-12HB-08DV	3/4"	5.47"	2.19"
PW-16RU-ET45-16HB-08DV	1"	6.02"	2.55"
PW-16RU-ET45-24HB-08DV	1 1/2"	5.33"	2.21"
PW-16RU-ET45-32HB-08DV	2"	8.04"	2.61"
1 1/2" ANSI Flange			
PW-24RU-ET45-06HB-08DV	3/8"	C/F	C/F
PW-24RU-ET45-08HB-08DV	1/2"	C/F	C/F
PW-24RU-ET45-12HB-08DV	3/4"	C/F	C/F
PW-24RU-ET45-16HB-08DV	1"	C/F	C/F
PW-24RU-ET45-24HB-08DV	1 1/2"	C/F	C/F
PW-24RU-ET45-32HB-08DV	2"	C/F	C/F
2" ANSI Flange			
PW-32RU-ET45-06HB-08DV	3/8"	C/F	C/F
PW-32RU-ET45-08HB-08DV	1/2"	C/F	C/F
PW-32RU-ET45-12HB-08DV	3/4"	C/F	C/F
PW-32RU-ET45-16HB-08DV	1"	C/F	C/F
PW-32RU-ET45-24HB-08DV	1 1/2"	C/F	C/F
PW-32RU-ET45-32HB-08DV	2"	C/F	C/F
3" ANSI Flange			
PW-48RU-ET45-06HB-08DV	3/8"	5.89"	1.19"
PW-48RU-ET45-08HB-08DV	1/2"	6.55"	1.86"
PW-48RU-ET45-12HB-08DV	3/4"	6.87"	2.19"
PW-48RU-ET45-16HB-08DV	1"	7.48"	2.66"
PW-48RU-ET45-24HB-08DV	1 1/2"	7.28"	2.21"
PW-48RU-ET45-32HB-08DV	2"	7.91"	2.61"

150# ANSI Flanges



ANSI VAN Stone FLG x Tee W/ 3/8" Thru 2" Ends

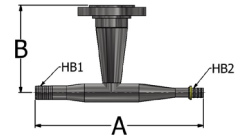

1" ANSI Flange				
Part Number	"HB1" Size	"HB2" Size	Dim "A"	Dim "B"
PW-16RU-16TT-06HB	3/8"	3/8"	6.66"	2.85"
PW-16RU-16TT-08HB-06HB	1/2"	3/8"	6.86"	2.85"
PW-16RU-16TT-08HB	1/2"	1/2"	9.00"	2.85"
PW-16RU-16TT-12HB-06HB	3/4"	3/8"	9.26"	2.85"
PW-16RU-16TT-12HB-08HB	3/4"	1/2"	9.20"	2.85"
PW-16RU-16TT-12HB	3/4"	3/4"	9.85"	2.85"
PW-16RU-16TT-16HB-06HB	1"	3/8"	9.52"	2.85"
PW-16RU-16TT-16HB-08HB	1"	1/2"	7.69"	2.85"
PW-16RU-16TT-16HB-12HB	1"	3/4"	10.11"	2.85"
PW-16RU-16TT-16HB	1"	1"	6.36"	2.85"
PW-16RU-24TT-24HB-06HB	1-1/2"	3/8"	15.77"	4.84"
PW-16RU-24TT-24HB-08HB	1-1/2"	1/2"	15.96"	4.84"
PW-16RU-24TT-24HB-12HB	1-1/2"	3/4"	15.55"	4.84"
PW-16RU-24TT-24HB-16HB	1-1/2"	1"	13.62"	4.84"
PW-16RU-32TT-24HB	1-1/2"	1-1/2"	14.78"	4.84"
PW-16RU-32TT-32HB-06HB	2"	3/8"	13.77"	4.84"
PW-16RU-32TT-32HB-08HB	2"	1/2"	13.96"	4.84"
PW-16RU-32TT-32HB-12HB	2"	3/4"	14.36"	4.84"
PW-16RU-32TT-32HB-16HB	2"	1"	13.61"	4.84"
PW-16RU-32TT-32HB-24HB	2"	1-1/2"	12.99"	4.84"
PW-16RU-32TT-32HB	2"	2"	10.99"	4.84"

1-1/2" ANSI Flange				
Part Number	"HB1" Size	"HB2" Size	Dim "A"	Dim "B"
PW-24RU-16TT-06HB	3/8"	3/8"	6.66"	2.89"
PW-24RU-16TT-08HB-06HB	1/2"	3/8"	6.86"	2.89"
PW-24RU-16TT-08HB	1/2"	1/2"	9.00"	2.89"
PW-24RU-16TT-12HB-06HB	3/4"	3/8"	9.26"	2.89"
PW-24RU-16TT-12HB-08HB	3/4"	1/2"	9.20"	2.89"
PW-24RU-16TT-12HB	3/4"	3/4"	9.85"	2.89"
PW-24RU-16TT-16HB-06HB	1"	3/8"	9.52"	2.89"
PW-24RU-16TT-16HB-08HB	1"	1/2"	7.69"	2.89"
PW-24RU-16TT-16HB-12HB	1"	3/4"	10.11"	2.89"
PW-24RU-16TT-16HB	1"	1"	6.36"	2.89"
PW-24RU-32TT-24HB-06HB	1-1/2"	3/8"	15.77"	3.48"
PW-24RU-32TT-24HB-08HB	1-1/2"	1/2"	15.96"	3.48"
PW-24RU-32TT-24HB-12HB	1-1/2"	3/4"	15.55"	3.48"
PW-24RU-32TT-24HB-16HB	1-1/2"	1"	14.36"	3.48"
PW-24RU-32TT-24HB	1-1/2"	1-1/2"	12.50"	3.48"
PW-24RU-32TT-32HB-06HB	2"	3/8"	13.77"	3.48"
PW-24RU-32TT-32HB-08HB	2"	1/2"	13.96"	3.48"
PW-24RU-32TT-32HB-12HB	2"	3/4"	14.36"	3.48"
PW-24RU-32TT-32HB-16HB	2"	1"	13.61"	3.48"
PW-24RU-32TT-32HB-24HB	2"	1-1/2"	12.99"	3.48"
PW-24RU-32TT-32HB	2"	2"	10.99"	3.48"

150# ANSI Flanges



ANSI VAN Stone FLG x Tee W/ 3/8" Thru 2" Ends

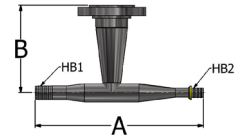

2" ANSI Flange				
Part Number	"HB1" Size	"HB2" Size	Dim "A"	Dim "B"
PW-32RU-16TT-06HB	3/8"	3/8"	6.66"	3.05"
PW-32RU-16TT-08HB-06HB	1/2"	3/8"	6.86"	3.05"
PW-32RU-24TT-08HB	1/2"	1/2"	10.07"	3.60"
PW-32RU-24TT-12HB-06HB	3/4"	3/8"	10.32"	3.60"
PW-32RU-24TT-12HB-08HB	3/4"	1/2"	10.49"	3.60"
PW-32RU-24TT-12HB	3/4"	3/4"	10.91"	3.60"
PW-32RU-24TT-16HB-06HB	1"	3/8"	10.58"	3.60"
PW-32RU-24TT-16HB-08HB	1"	1/2"	8.75"	3.60"
PW-32RU-24TT-16HB-12HB	1"	3/4"	11.17"	3.60"
PW-32RU-24TT-16HB	1"	1"	7.42"	3.60"
PW-32RU-32TT-24HB-06HB	1-1/2"	3/8"	15.77"	5.16"
PW-32RU-32TT-24HB-08HB	1-1/2"	1/2"	15.96"	5.16"
PW-32RU-32TT-24HB-12HB	1-1/2"	3/4"	15.55"	5.16"
PW-32RU-32TT-24HB-16HB	1-1/2"	1"	13.62"	5.16"
PW-32RU-32TT-24HB	1-1/2"	1-1/2"	14.78"	5.16"
PW-32RU-32TT-32HB-06HB	2"	3/8"	13.77"	5.16"
PW-32RU-32TT-32HB-08HB	2"	1/2"	13.96"	5.16"
PW-32RU-32TT-32HB-12HB	2"	3/4"	14.36"	5.16"
PW-32RU-32TT-32HB-16HB	2"	1"	13.61"	5.16"
PW-32RU-32TT-32HB-24HB	2"	1-1/2"	14.88"	4.56"
PW-32RU-32TT-32HB	2"	2"	11.48"	5.00"

3" ANSI Flange				
Part Number	"HB1" Size	"HB2" Size	Dim "A"	Dim "B"
PW-48RU-16TT-06HB	3/8"	3/8"	6.66"	3.25"
PW-48RU-16TT-08HB-06HB	1/2"	3/8"	6.86"	3.25"
PW-48RU-16TT-08HB	1/2"	1/2"	9.00"	3.25"
PW-48RU-16TT-12HB-06HB	3/4"	3/8"	9.26"	3.25"
PW-48RU-16TT-12HB-08HB	3/4"	1/2"	9.20"	3.25"
PW-48RU-16TT-12HB	3/4"	3/4"	9.85"	3.25"
PW-48RU-16TT-16HB-06HB	1"	3/8"	9.52"	3.25"
PW-48RU-16TT-16HB-08HB	1"	1/2"	7.69"	3.25"
PW-48RU-16TT-16HB-12HB	1"	3/4"	10.11"	3.25"
PW-48RU-16TT-16HB	1"	1"	6.36"	3.25"
PW-48RU-32TT-24HB-06HB	1-1/2"	3/8"	15.77"	3.84"
PW-48RU-32TT-24HB-08HB	1-1/2"	1/2"	15.96"	3.84"
PW-48RU-32TT-24HB-12HB	1-1/2"	3/4"	15.55"	3.84"
PW-48RU-32TT-24HB-16HB	1-1/2"	1"	13.62"	3.84"
PW-48RU-32TT-24HB	1-1/2"	1-1/2"	14.78"	3.84"
PW-48RU-32TT-32HB-06HB	2"	3/8"	13.77"	3.84"
PW-48RU-32TT-32HB-08HB	2"	1/2"	13.96"	3.84"
PW-48RU-32TT-32HB-12HB	2"	3/4"	14.36"	3.84"
PW-48RU-32TT-32HB-16HB	2"	1"	13.61"	3.84"
PW-48RU-32TT-32HB-24HB	2"	1-1/2"	12.99"	3.84"
PW-48RU-32TT-32HB	2"	2"	10.99"	3.84"

MNPT TEES

MNPT W/SS Union

x Tee W/ HB 3/8" Thru 2" Ends

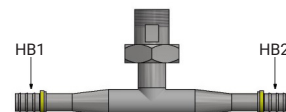

1.5" MNPT		
Part Number	"HB1" Size	"HB2" Size
PW-24MRA-16TT-06HB	3/8"	3/8"
PW-24MRA-16TT-08HB-06HB	1/2"	3/8"
PW-24MRA-16TT-08HB	1/2"	1/2"
PW-24MRA-16TT-12HB-06HB	3/4"	3/8"
PW-24MRA-16TT-12HB-08HB	3/4"	1/2"
PW-24MRA-16TT-12HB	3/4"	3/4"
PW-24MRA-16TT-16HB-06HB	1"	3/8"
PW-24MRA-16TT-16HB-08HB	1"	1/2"
PW-24MRA-16TT-16HB-12HB	1"	3/4"
PW-24MRA-16TT-16HB	1"	1"
PW-24MRA-32TT-24HB-06HB	1-1/2"	3/8"
PW-24MRA-32TT-24HB-08HB	1-1/2"	1/2"
PW-24MRA-32TT-24HB-12HB	1-1/2"	3/4"
PW-24MRA-32TT-24HB-16HB	1-1/2"	1"
PW-24MRA-32TT-24HB	1-1/2"	1-1/2"
PW-24MRA-32TT-32HB-06HB	2"	3/8"
PW-24MRA-32TT-32HB-08HB	2"	1/2"
PW-24MRA-32TT-32HB-12HB	2"	3/4"
PW-24MRA-32TT-32HB-16HB	2"	1"
PW-24MRA-32TT-32HB-24HB	2"	1-1/2"
PW-24MRA-32TT-32HB	2"	2"

2" MNPT		
Part Number	"HB1" Size	"HB2" Size
PW-32MRA-16TT-06HB	3/8"	3/8"
PW-32MRA-16TT-08HB-06HB	1/2"	3/8"
PW-32MRA-24TT-08HB	1/2"	1/2"
PW-32MRA-24TT-12HB-06HB	3/4"	3/8"
PW-32MRA-24TT-12HB-08HB	3/4"	1/2"
PW-32MRA-24TT-12HB	3/4"	3/4"
PW-32MRA-24TT-16HB-06HB	1"	3/8"
PW-32MRA-24TT-16HB-08HB	1"	1/2"
PW-32MRA-24TT-16HB-12HB	1"	3/4"
PW-32MRA-24TT-16HB	1"	1"
PW-32MRA-32TT-24HB-06HB	1-1/2"	3/8"
PW-32MRA-32TT-24HB-08HB	1-1/2"	1/2"
PW-32MRA-32TT-24HB-12HB	1-1/2"	3/4"
PW-32MRA-32TT-24HB-16HB	1-1/2"	1"
PW-32MRA-32TT-24HB	1-1/2"	1-1/2"
PW-32MRA-32TT-32HB-06HB	2"	3/8"
PW-32MRA-32TT-32HB-08HB	2"	1/2"
PW-32MRA-32TT-32HB-12HB	2"	3/4"
PW-32MRA-32TT-32HB-16HB	2"	1"
PW-32MRA-32TT-32HB-24HB	2"	1-1/2"
PW-32MRA-32TT-32HB	2"	2"

MNPT ADAPTERS

MNPT W/SS Union

x 90° Elbow W/ 3/8" Thru 2" HB End W/ 1/2" Vent/Drain Valve



1-1/2" MNPT	
Part Number	HB Size
PW-24MRA-ET-06HB-08DV	3/8"
PW-24MRA-ET-08HB-08DV	1/2"
PW-24MRA-ET-12HB-08DV	3/4"
PW-24MRA-ET-16HB-08DV	1"
PW-24MRA-ET-24HB-08DV	1 1/2"
PW-24MRA-ET-32HB-08DV	2"
2" MNPT	
PW-32MRA-ET-06HB-08DV	3/8"
PW-32MRA-ET-08HB-08DV	1/2"
PW-32MRA-ET-12HB-08DV	3/4"
PW-32MRA-ET-16HB-08DV	1"
PW-32MRA-ET-24HB-08DV	1 1/2"
PW-32MRA-ET-32HB-08DV	2"

MNPT W/SS Union

x 45° Elbow W/ 3/8" Thru 2" HB End W/ 1/2" Vent/Drain Valve

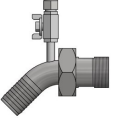

1-1/2" MNPT	
Part Number	HB Size
PW-24MRA-ET45-06HB-08DV	3/8"
PW-24MRA-ET45-08HB-08DV	1/2"
PW-24MRA-ET45-12HB-08DV	3/4"
PW-24MRA-ET45-16HB-08DV	1"
PW-24MRA-ET45-24HB-08DV	1 1/2"
PW-24MRA-ET45-32HB-08DV	2"
2" MNPT	
PW-32MRA-ET45-06HB-08DV	3/8"
PW-32MRA-ET45-08HB-08DV	1/2"
PW-32MRA-ET45-12HB-08DV	3/4"
PW-32MRA-ET45-16HB-08DV	1"
PW-32MRA-ET45-24HB-08DV	1 1/2"
PW-32MRA-ET45-32HB-08DV	2"

MNPT W/ SS Union

W/ Straight 3/8" thru 2" HB End with 1/2" Vent/Drain Valve

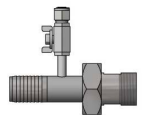

1-1/2" MNPT	
Part Number	HB Size
PW-24MRA-06HB-08DV	3/8"
PW-24MRA-08HB-08DV	1/2"
PW-24MRA-12HB-08DV	3/4"
PW-24MRA-16HB-08DV	1"
PW-24MRA-24HB-08DV	1 1/2"
PW-24MRA-32HB-08DV	2"

2" MNPT	
Part Number	HB Size
PW-32MRA-06HB-08DV	3/8"
PW-32MRA-08HB-08DV	1/2"
PW-32MRA-12HB-08DV	3/4"
PW-32MRA-16HB-08DV	1"
PW-32MRA-24HB-08DV	1 1/2"
PW-32MRA-32HB-08DV	2"

HB X Tube Adapters

1" S.S. TUBE X HB 90 ° ELBOW

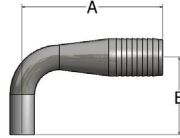

Part Number	"HB1" Size	Tube	Dim "A"	Dim "B"
PW-24HB-ET-16T	1 1/2"	1"	5.7"	3.1"
PW-16HB-ET-16T	1"	1"	6.1"	3.0"
PW-12HB-ET-16T	3/4"	1"	4.9"	3.0"

1" S.S. TUBE X HB 45 ° ELBOW

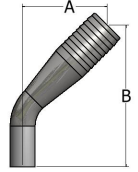

Part Number	"HB1" Size	Tube	Dim "A"	Dim "B"
PW-24HB-ET45-16T	1 1/2"	1"	3.4"	5.7"
PW-16HB-ET45-16T	1"	1"	3.8"	6.0"
PW-12HB-ET45-16T	3/4"	1"	2.9"	5.2"

S.S. HB PLUG X COMPRESSION CAP

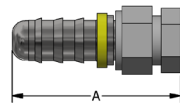

Part Number	"HB1" Size	Dim "A"
PW-08HB-CC	1/2"	C/F
PW-12HB-CC	3/4"	C/F
PW-16HB-CC	1"	3.22"

PW Stick Adapters

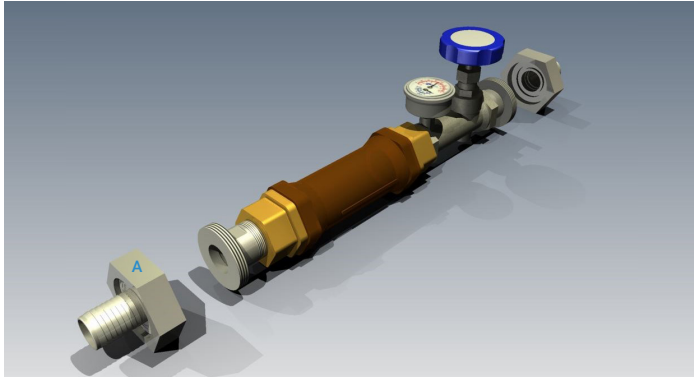

A: Female nuts come supplied with sticks, & SP-valves, hose barb fittings to be ordered separately

Water Stick Fittings *End connection fittings on this page to be ordered separately for PCWS/R sticks & SP-valves supplied with union end connections.

Evans S.S. O-Ring Wafer

For Union ("O" Ring Included)

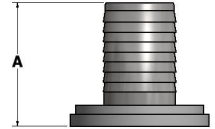

Part Number	"HB1" Size	PCW STICK SIZE	O-RING WAFER SIZE	DIM "A"
PW-24HB-16OW	1.5"	1"	1"	2.6"
PW-24HB-20OW	1.5"	1.5"	1.25"	2.7"
PW-32HB-20OW	2"	1.5"	1.25"	4.9"
PW-24HB-28OW	1.5"	2"	1.75"	4.6"
PW-32HB-28OW	2"	2"	1.75"	2.9"

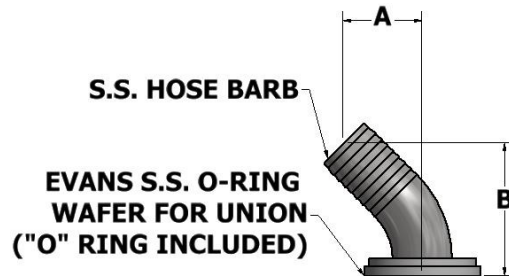
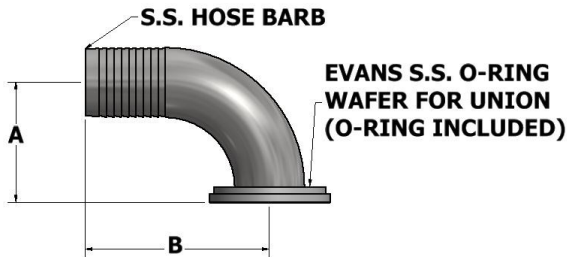

PART NUMBER	"HB1" Size	PCW Stick Size	O-Ring Wafer	DIM "A"	DIM "B"
PW-24HB-ET-16OW	1.5"	1"	1"	5.7"	1.9"
PW-24HB-ET-20OW	1.5"	1.5"	1.25"	2.7"	4.4"
PW-32HB-ET-20OW	2"	1.5"	1.25"	3.5"	5.4"
PW-24HB-ET-28OW	1.5"	2"	1.75"	4.7"	4.4"
PW-32HB-ET-28OW	2"	2"	1.75"	3.4"	5.4"

PART NUMBER	"HB1" Size	PCW Stick Size	O-Ring Wafer	DIM "A"	DIM "B"
PW-24HB-ET45-16OW	1.5"	1"	1"	2.2"	3.6"
PW-24HB-ET45-20OW	1.5"	1.5"	1.25"	2.2"	3.6"
PW-32HB-ET45-20OW	2"	1.5"	1.25"	2.6"	4.4"
PW-24HB-ET45-28OW	1.5"	2"	1.75"	2.2"	5.6"
PW-32HB-ET45-28OW	2"	2"	1.75"	2.6"	4.3"

Union Adapters

Evans 304SS MNPT x SS Threaded Wafer

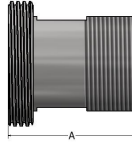

PART NUMBER	DESCRIPTION	DIM "A"
PW-16F-20TW	1" 304SS FNPT x 1-1/2" RED. THREADED WAFER (NOT PICTURED)	1.3"
PW-24M-20TW	1-1/2" 304SS MNPT x 1-1/2" RED. THREADED WAFER	2.6"
PW-24M-28TW	1-1/2" 304SS MNPT x 2" RED. THREADED WAFER	2.6"
PW-32M-28TW	2" 304SS MNPT x 2" RED. THREADED WAFER	3.0"

Evans SS O-Ring Wafer x 304SS FNPT/MNPT FTG

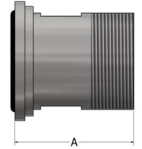

PART NUMBER	DESCRIPTION	DIM "A"
PW-16F-200W	1" FNPT X 1-1/2" RED. O-RING WAFER (NOT PICTURED)	1.3"
PW-24M-200W	1-1/2" MNPT X 1-1/2" RED. O-RING WAFER	2.6"
PW-24M-280W	1-1/2" MNPT X 2" RED. O-RING WAFER	2.5"
PW-32M-280W	2" MNPT X 2" RED. O-RING WAFER	2.9"

Evans 304SS MNPT 7" LG x SS Threaded Wafer

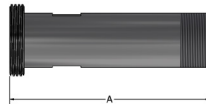

PART NUMBER	DESCRIPTION	DIM "A"
PW-24M-20TW-7	1-1/2" 304SS MNPT 7" LONG x RED. THREADED WAFER	7.0"
PW-32M-28TW-7	2" 304SS MNPT 7" LONG x RED. THREADED WAFER	7.0"

Evans SS Union Nut



PART NUMBER	DESCRIPTION	DIM "A"
PW-20-SN	SS NUT FOR EVANS 1-1/2" REDUCED UNION	1.1"
PW-28-SN	SS NUT FOR EVANS 2" REDUCED UNION	1.1"

Evans SS O-Ring Wafer x Evans Presslok

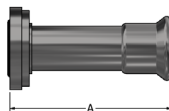

PART NUMBER	DESCRIPTION	DIM "A"
PW-08PL*-OW	1/2" PRESSLOK X 1/2" O-RING WAFER	C/F
PW-12PL*-OW	3/4" PRESSLOK X 3/4" O-RING WAFER	C/F
PW-16PL*-OW	1" PRESSLOK X 1" O-RING WAFER	C/F
PW-24PL*-200W	1-1/2" PRESSLOK X 1-1/2" RED. O-RING WAFER	C/F
PW-32PL*-280W	2" PRESSLOK X 2" RED. O-RING WAFER	C/F

Evans SS O-Ring Wafer x Tube Extension

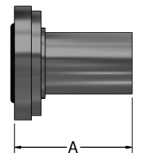

PART NUMBER	DESCRIPTION	DIM "A"
PW-08T-OW	1/2" TUBE X 1/2" O-RING WAFER	C/F
PW-12T-OW	3/4" TUBE X 3/4" O-RING WAFER	C/F
PW-16T-OW	1" TUBE X 1" O-RING WAFER	C/F
PW-24T-200W	1-1/2" TUBE X 1-1/2" RED. O-RING WAFER	C/F
PW-32T-280W	2" TUBE X 2" RED. O-RING WAFER	C/F

* - Insert V for Viton O-ring, E for EPDM o-ring

Ball Valves

Ball Valve

w/ HB x HB or HB Union Ends (A)

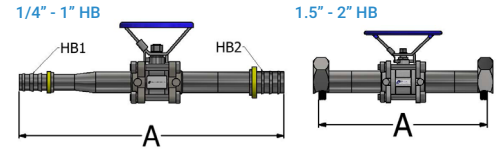

Figure Number	Side A	Valve Size	Side B	Dim "A"
PW-08-STR04HB-04HB-2-TS-OH	1/4"	1/2"	1/4"	C/F
PW-08-STR04HB-06HB-2-TS-OH	1/4"	1/2"	3/8"	C/F
PW-08-STR04HB-HB-2-TS-OH	1/2"	1/2"	1/4"	C/F
PW-08-STR06HB-HB-2-TS-OH	1/2"	1/2"	3/8"	C/F
PW-08-STRHB-2-TS-OH	1/2"	1/2"	1/2"	C/F
PW-08-STR12HB-HB-2-TS-OH	3/4"	1/2"	1/2"	C/F
PW-12-STR06HB-HB-2-TS-OH	3/4"	3/4"	3/8"	C/F
PW-12-STR08HB-HB-2-TS-OH	3/4"	3/4"	1/2"	C/F
PW-12-STRHB-2-TS-OH	3/4"	3/4"	3/4"	C/F
PW-12-STR16HB-HB-2-TS-OH	1"	3/4"	3/4"	C/F
PW-16-STR08HB-HB-2-TS-OH	1"	1"	1/2"	C/F
PW-16-STR12HB-HB-2-TS-OH	1"	1"	3/4"	C/F
PW-16-STRHB-2-TS-OH	1"	1"	1"	C/F
PW-16-STRA-HB-2-TS-OH	1 1/2"	1"	1"	C/F
PW-24-STR12HB-RA-2-TS-OH	1 1/2"	1 1/2"	3/4"	C/F
PW-24-STR16HB-RA-2-TS-OH	1 1/2"	1 1/2"	1"	C/F
PW-24-STRRA-2-TS-OH	1 1/2"	1 1/2"	1 1/2"	C/F
PW-24-STRRA-2-TS-OH	2"	1 1/2"	1 1/2"	C/F
PW-32-STRRA-2-TS-OH	2"	2"	1 1/2"	C/F
PW-32-STRRA-2-TS-OH	2"	2"	2"	C/F

Ball Valves

Ball Valve

w/ HB or HB union (A) x Flange Ends (U)

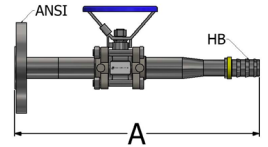

Figure Number	Side A (Hose Barb)	Valve Size	Side B (Flange)	Dim "A"
PW-08-STR06HB-16U-2-TS-OH	3/8"	1/2"	1"	C/F
PW-08-STRHB-16U-2-TS-OH	1/2"	1/2"	1"	C/F
PW-08-STRHB-24U-2-TS-OH	1/2"	1/2"	1 1/2"	C/F
PW-12-STR08HB-16U-2-TS-OH	1/2"	3/4"	1"	C/F
PW-12-STRHB-16U-2-TS-OH	3/4"	3/4"	1"	C/F
PW-12-STR08HB-24U-2-TS-OH	1/2"	3/4"	1 1/2"	C/F
PW-12-STRHB-24U-2-TS-OH	3/4"	3/4"	1 1/2"	C/F
PW-16-STR12HB-U-2-TS-OH	3/4"	1"	1"	C/F
PW-16-STRHB-U-2-TS-OH	1"	1"	1"	C/F
PW-16-STR12HB-24U-2-TS-OH	3/4"	1"	1 1/2"	C/F
PW-16-STRHB-24U-2-TS-OH	1"	1"	1 1/2"	C/F
PW-24-STR16HB-24U-2-TS-OH	1"	1 1/2"	1 1/2"	C/F
PW-24-STRRA-U-2-TS-OH	1 1/2"	1 1/2"	1 1/2"	C/F
PW-24-STRRA-16U-2-TS-OH	1 1/2"	1 1/2"	1"	C/F
PW-32-STRRA-U-2-TS-OH	1 1/2"	2"	2"	C/F
PW-32-STRRA-U-2-TS-OH	2"	2"	2"	C/F
PW-32-STRRA-16U-2-TS-OH	2"	2"	1"	C/F

Globe Valves

Globe Valve

Valve w/ HB x HB or HB Union Ends (A)

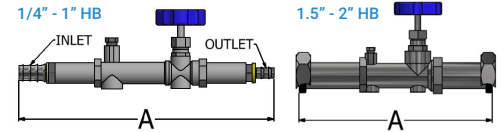

Figure Number	Inlet	Valve Size	Outlet	Dim "A"
PW-08-GV04HB-04HB-2	1/4"	1/2"	1/4"	C/F
PW-08-GV04HB-06HB-2	1/4"	1/2"	3/8"	C/F
PW-08-GV04HB-HB-2	1/4"	1/2"	1/2"	C/F
PW-08-GV06HB-04HB-2	3/8"	1/2"	1/4"	C/F
PW-08-GV06HB-06HB-2	3/8"	1/2"	3/8"	C/F
PW-08-GV06HB-HB-2	3/8"	1/2"	1/2"	C/F
PW-08-GVHB-04HB-2	1/2"	1/2"	1/4"	C/F
PW-08-GVHB-06HB-2	1/2"	1/2"	3/8"	C/F
PW-08-GVHB-2	1/2"	1/2"	1/2"	C/F
PW-12-GV06HB-HB-2	3/8"	3/4"	3/4"	C/F
PW-12-GVHB-06HB-2	3/4"	3/4"	3/8"	C/F
PW-12-GV08HB-HB-2	1/2"	3/4"	3/4"	C/F
PW-12-GVHB-08HB-2	3/4"	3/4"	1/2"	C/F
PW-12-GVHB-2	3/4"	3/4"	3/4"	C/F
PW-16-GV08HB-HB-2	1/2"	1"	1"	C/F
PW-16-GVHB-08HB-2	1"	1"	1/2"	C/F
PW-16-GV12HB-HB-2	3/4"	1"	1"	C/F
PW-16-GVHB-12HB-2	1"	1"	3/4"	C/F
PW-16-GVHB-2	1"	1"	1"	C/F
PW-24-GV16HB-RA-2	1"	1 1/2"	1 1/2"	C/F
PW-24-GVRA-16HB-2	1 1/2"	1 1/2"	1"	C/F
PW-24-GVRA-2	1 1/2"	1 1/2"	1 1/2"	C/F
PW-32-GVRA-2	1 1/2"	2"	2"	C/F
PW-32-GVRA-2	2"	2"	1 1/2"	C/F
PW-32-GVRA-2	2"	2"	2"	C/F

Learn more about related Evans Products

EVANS COMPONENTS | Evans PLT Series Presslok® Stainless Tube Fittings/Valves
Tube Size Range: 1/2" thru 4"



PRESSLOK® GO/NO-GO GAUGES

If Presslok® Go/No-Go Gauge slips over pressed section of fitting, press is acceptable.
If gauge does not slip over pressed section, press is unacceptable.

EVANS COMPONENTS | Evans PW Series
1/2" thru 4" PCWS/R Hook Up Sticks



Evans Custom Water Stick
Supply and Return Manifolds

EVANS COMPONENTS | Evans Ball Valves
PW "Industrial" Series



PW Series

- Full Port Design
- 1/4" - 6" Size Range
- Integrated Valve Assemblies
- Spool Manifolds up to 24' (7m) Lengths
- One-piece ANSI 150lb Flange Optional
- 100% Pressure Tested



www.evanscomponents.com

7606 SW Bridgeport Road
Portland, Oregon 97224

Office 971.249.1600

Fax 971.249.1601